



VANITIES

Installation Instructions, Care & Maintenance.

BEFORE YOU START	2
INSTALLATION INSTRUCTIONS VANITIES	3-4
INSTALLATION INSTRUCTIONS BASINS	5
INSTALLATION INSTRUCTIONS SEALING & ADJUSTING	6
DRAWER INSTALLATION & ALIGNMENT HETTICH DRAWER	7-8
ELECTRICAL STANDARDS	9
CARE & MAINTENANCE GUIDE	10
VANITY HANGING GUIDE	11-12
TROUBLESHOOTING	13
WARRANTY	14-15



Please keep me.

QUALIFIED TRADIE:

Are you installing this product? Please read the install instructions in this booklet **BEFORE** installation. If the product is not installed in accordance with these instructions, the warranty may be void and the homeowner may claim against you (the installer). Return this to the homeowner.

HOMEOWNER

If you are the homeowner, please read the important care, maintenance and warranty information. We advise you store this booklet somewhere safe and do not throw it away.

1. BEFORE YOU START

We recommend that a qualified trades person installs this product and we would expect the installation to be undertaken in a trades person like manner and finished to a trades person standard. Please inspect thoroughly before installation to ensure that the product has not been damaged. It is the responsibility of the installer to make any adjustments to doors/drawers after installation if required.



1.1 Positioning & Ventilation

- Furniture must be at least 150mm away from any wet areas (Fig. 1A)
- Do not expose furniture to shower spray
- It is important that your bathroom is adequately ventilated to eliminate moisture build up. High humidity will lead to permanent dampness and mould resulting in deterioration of the materials in your bathroom.

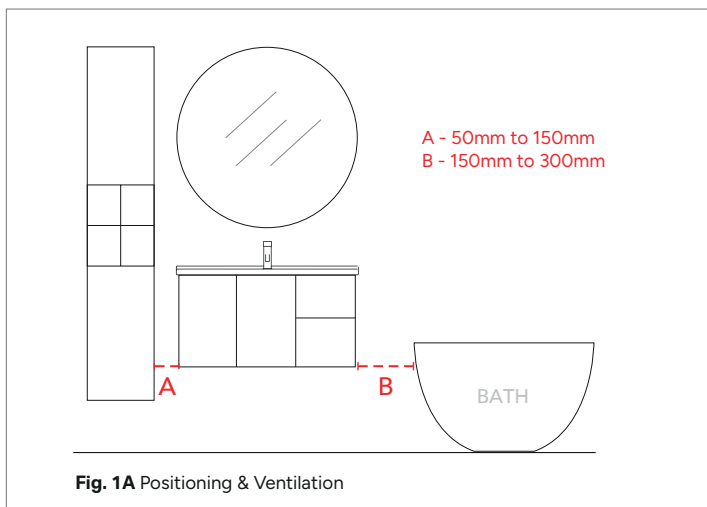

If it not possible to make the wall or floor plumb and straight you must pack the vanity out so that it does not follow the out of aligned wall.

Floorstanding vanities must sit on a level floor or be packed so they sit level and true.

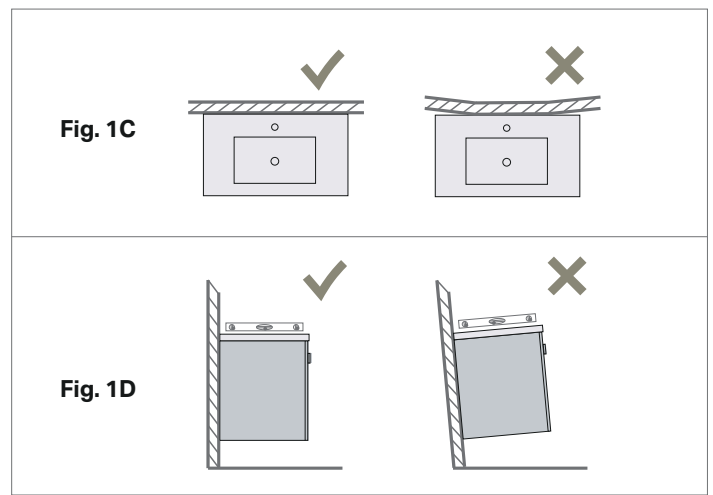

1.2 Check Support Nogs

Wall hung furniture require fixing to support nogs fitted between the studs, as detailed (Fig. 1B)*, to give a solid wall backing to attach the vanity. If necessary fix additional support nogs at desired height for cabinet fixing. Please ensure total width of support nog exceeds the vanity width.

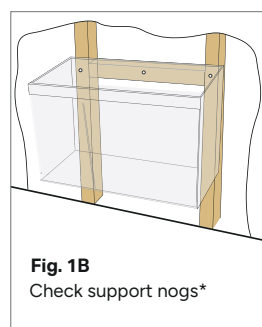

1.5 Which vanity solution do you have?

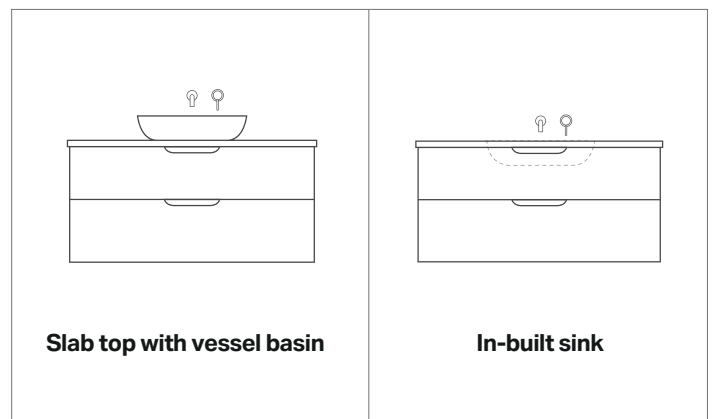

1.3 Check for Plumb Walls and Level Floors

Ensure the wall is plumb and straight, ensure floor is level (Fig 1C & 1D). If you fix the product to a non-plumb wall or floor the following could happen:

- Your door or drawers will not operate correctly.
- Door or drawer adjustments will not align.
- Basins will not sit level, which may cause water to pool or not drain correctly.

2. INSTALLATION INSTRUCTIONS | VANITIES

2.1 Measuring up

Mark the position of the top of the vanity. Factor in the top / basin thickness to get the correct height (Fig. 2A)

Use a single screw in the centre of the vanity to hold it in place.

Refer to page 11 and 12 for our vanity hanging guide.

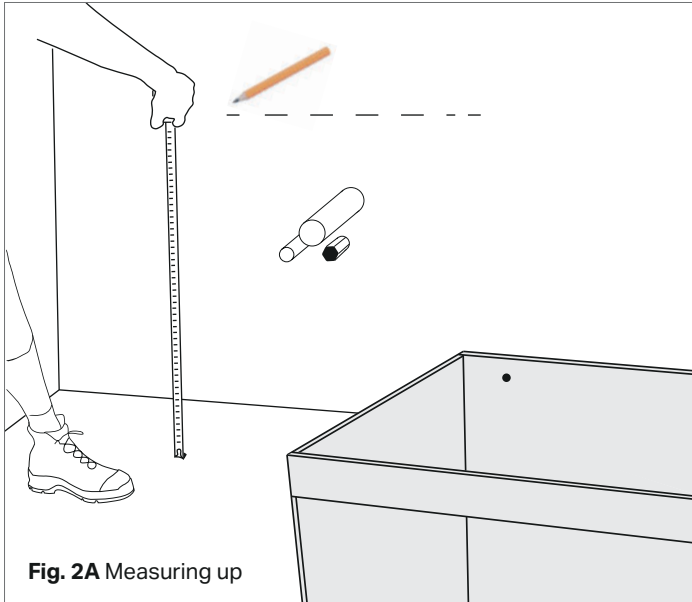

2.2 Preparing the cabinet

Remove doors & drawers and drill holes for plumbing in the back panel and/or base of the cabinet with an appropriate sized hole saw (Fig. 2B)

Pre-drill screw locations for fastening to wall in **Step 2.4**

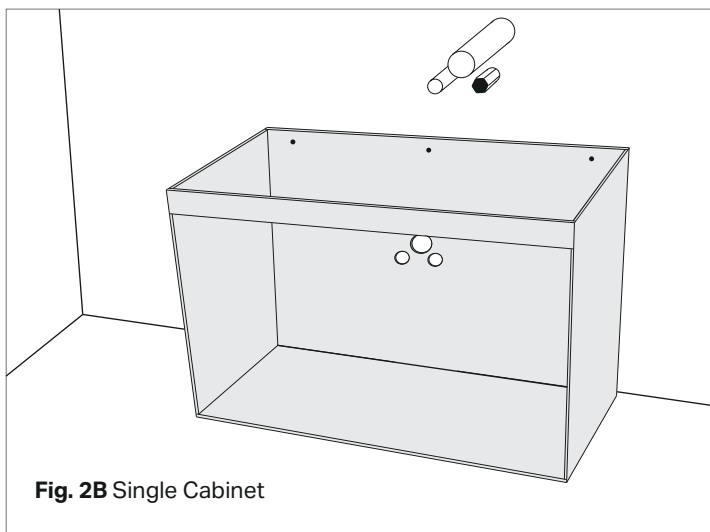

2.3 Levelling up

1. Level front & back (Fig. 2D)
2. Level across the diagonal (Fig. 2E)
3. Level sides (Fig. 2F)

NOTE: Floorstanding vanities should likewise, be checked for sitting level, plumb, square and suitably packed to achieve this. Fix to the wall to secure either through the back rail or back panel.

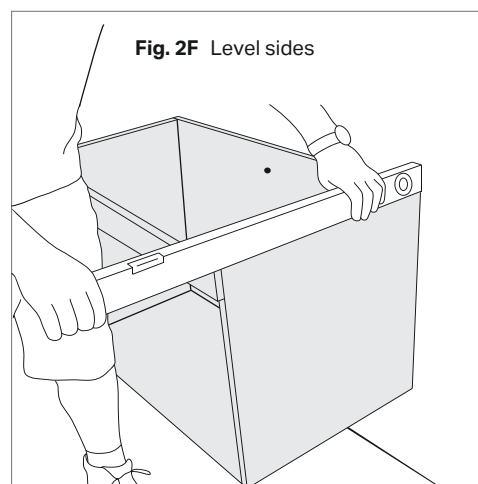
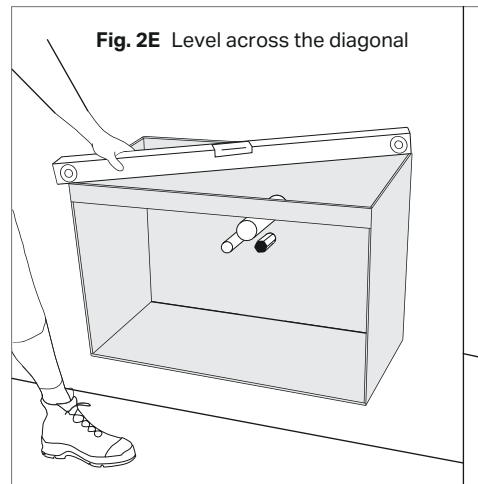
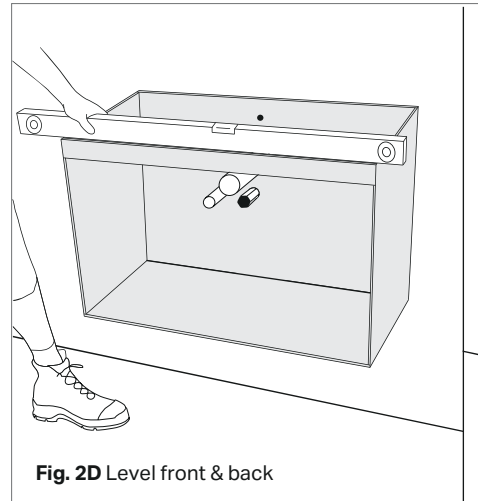

2. INSTALLATION INSTRUCTIONS | VANITIES

2.4 Securing the cabinet

Securely fasten the cabinet to the wall through the back, no further than 100mm from each side of the cabinet. Upper fixings should be no lower than 50mm from the top of the back. Where possible, fasten the cabinet through the steel bracket in the top corner of the unit.

Note: For cabinets over 900mm wide you must provide additional fixing points evenly spaced at 300mm.

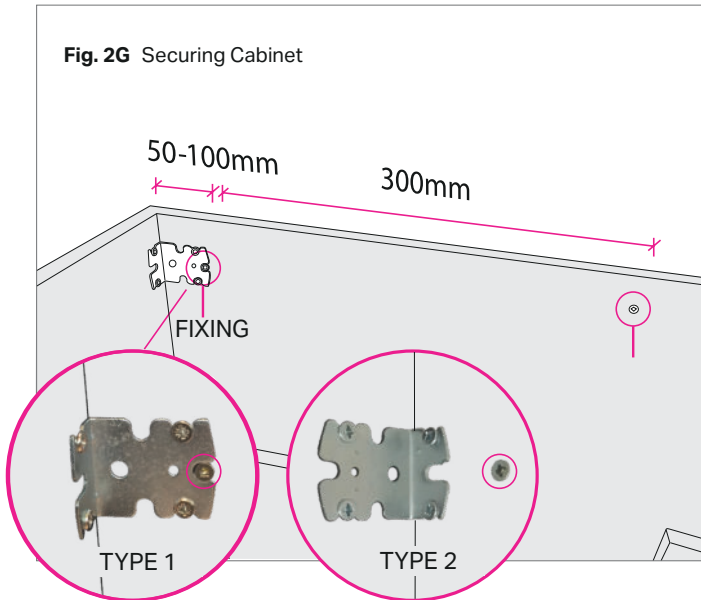

Special Note: For our Nature Vanity range, ensure fastening is through the steel bracket on each side.

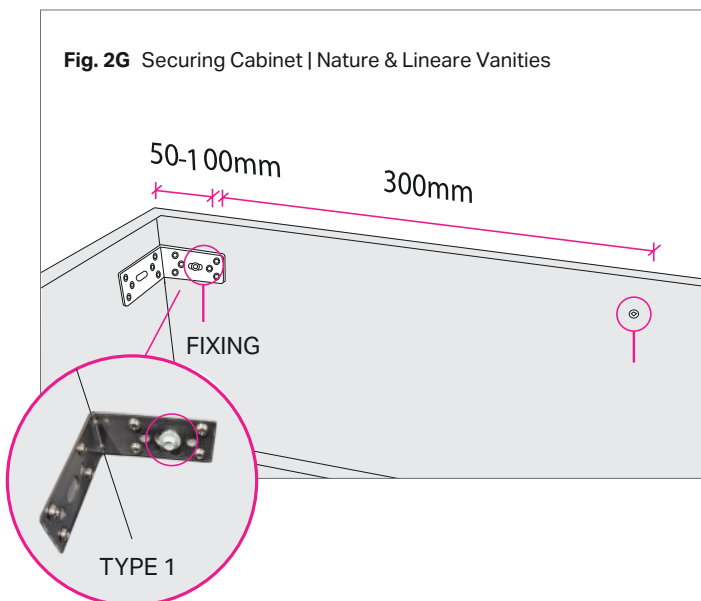

3. INSTALLATION INSTRUCTIONS | BASINS

3.1 Waste Installation

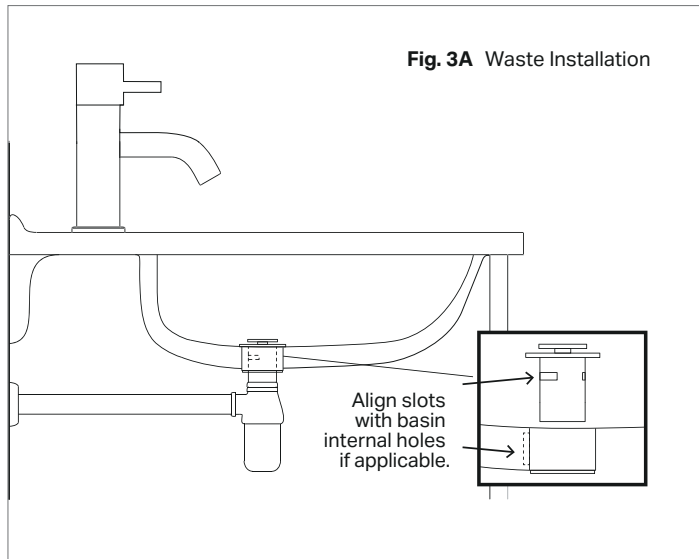

3.2 Fixing tops & basins

Position the top so that it has an equal amount of overhang on each side and use a level to ensure the vanity top surface is level.

Note: If the vanity is being installed in a corner, a packing strip maybe required and basin location will vary.

1. Apply silicone sealant (not included) to all four corners of the cabinet.
2. Place the vanity top/basin onto the cabinet.

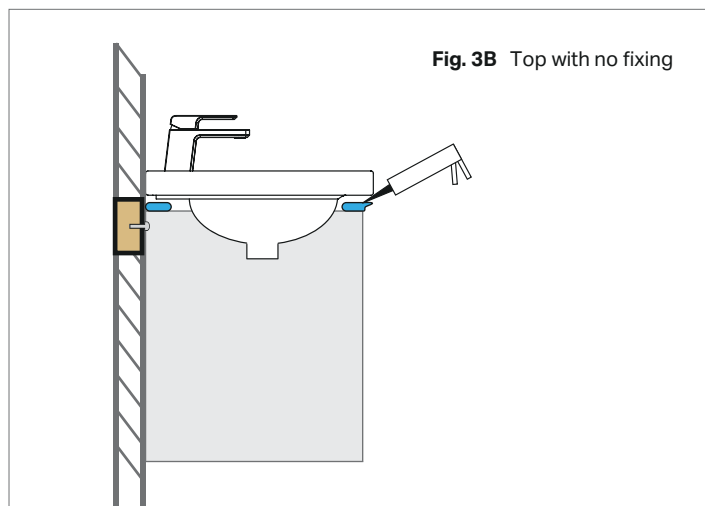

3.3 Fix Vessel Basins

NOTE - Future basin removal:
Basin replacement is an important factor to consider when fixing and sealing basins. By limiting silicone application as per instructions allows basin removal without damage to benchtops.

20mm silicone dots to hold the basin in place, limit to 3 fixing points to enable future basin removal. (Fig. 3C)

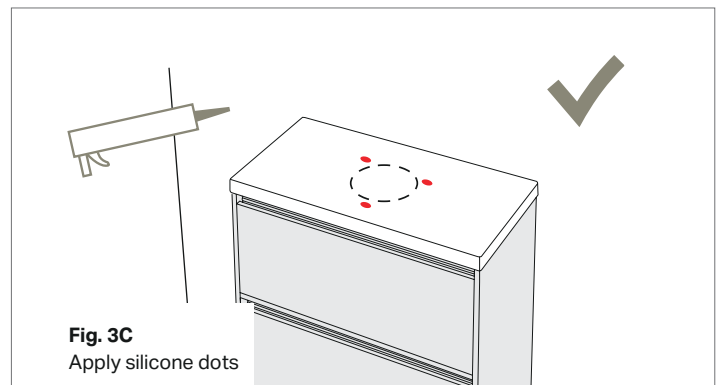

DO NOT apply a bed of silicone to fix the basin to the benchtop. (Fig. 3D)

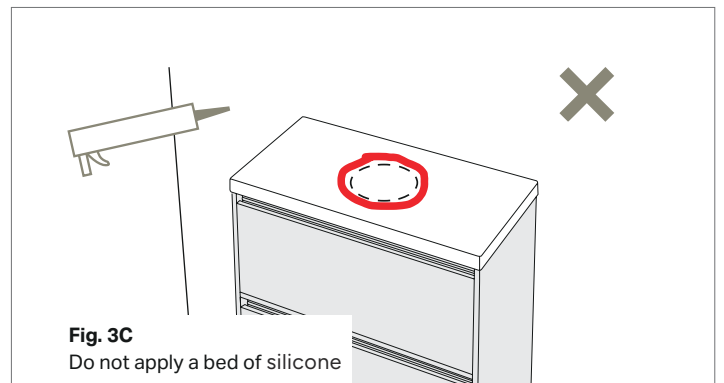

4. INSTALLATION INSTRUCTIONS | SEALING & ADJUSTING

4.1 Sealing

Apply silicone on the seam between the edge of the vanity top and the wall, smooth the bead and allow to cure before use.

Materials used for the construction of this unit are water resistant and not waterproof. A bead of sealant (specifically formulated for bathrooms) must be used to seal edges where water penetration can occur, i.e. between the basin and the cabinet, between the wall and the floor.

When sealing a vessel or semi-inset basin it is important to put a bead of silicone around the edge where the basin meets the top. As well as where the top meets the wall.

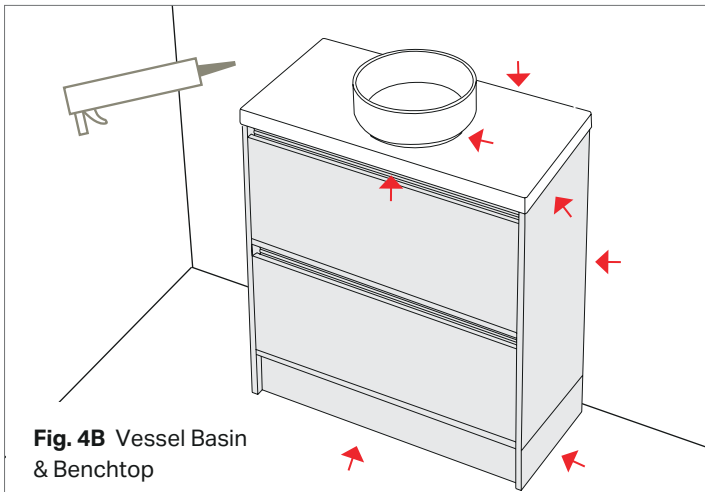
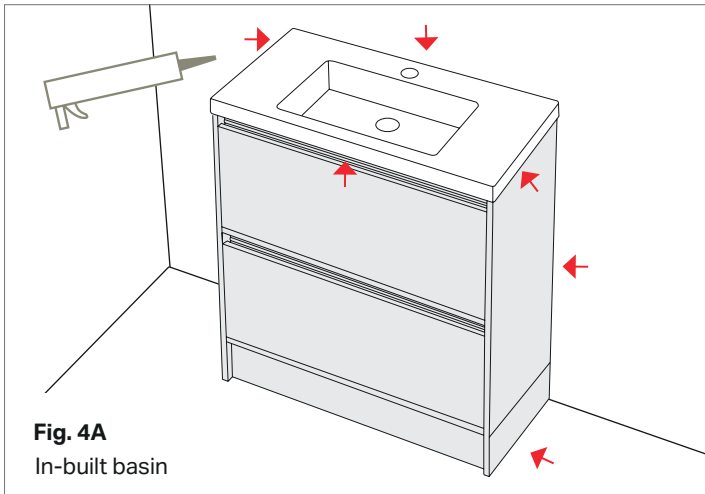

4.2 Final fitting & adjustment

NOTE:

The fitting & adjustment of door and drawers is the responsibility of **the installer**.

Please refer to Sections 5 (page 7-8) for adjustment instructions.

Install drawers & doors back onto the cabinet

Refer to adjustment Section 5 (page 7-8) for drawer adjustments.

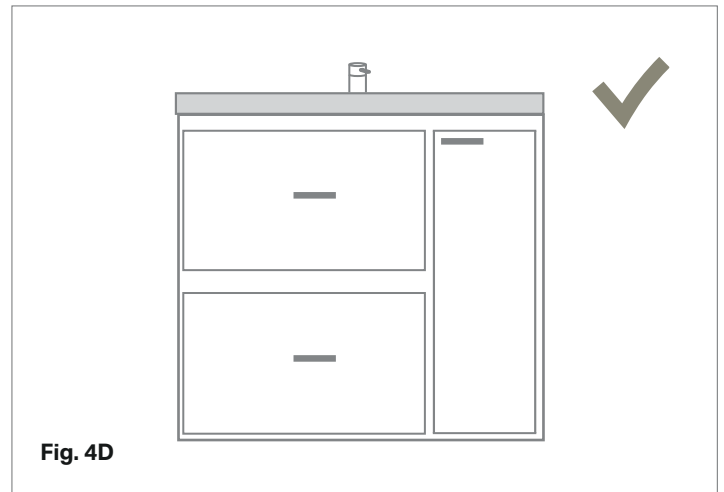
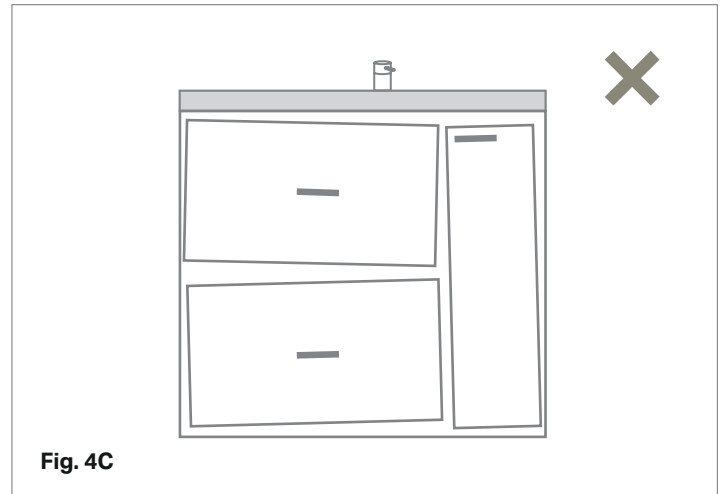

Note: Ensure doors and drawers are replaced back in the same position.

4. INSTALLATION INSTRUCTIONS | HETTICH DRAWER

5.1 Removing the drawer

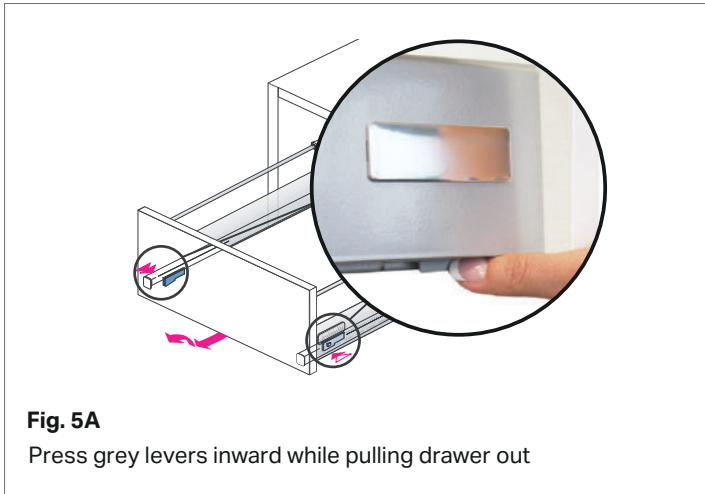

5.2 Inserting drawer

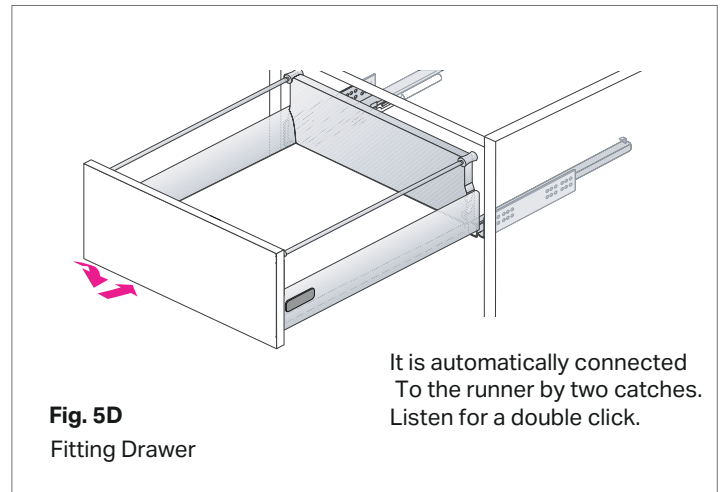
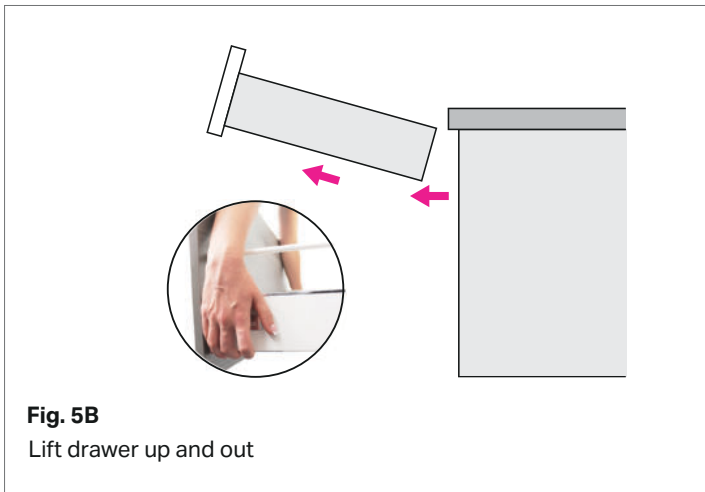
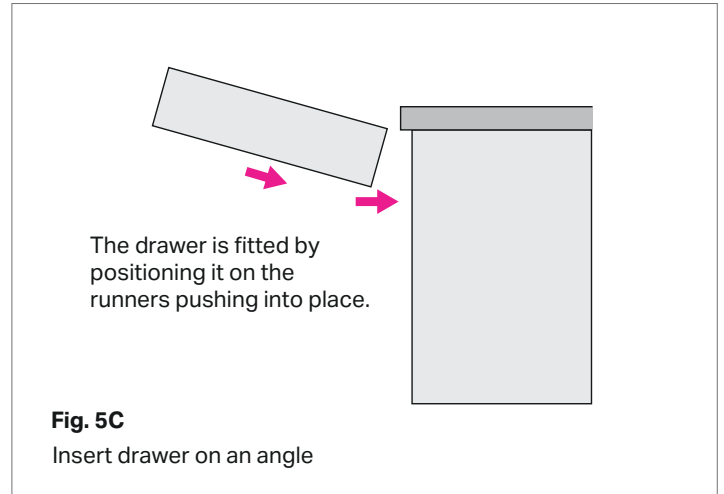

5.3 Adjustment

Adjust the drawer front as required

WARNING: Avoid pushing the blue button - this will cause the drawer front panel to detach.

Remove caps for adjustment and replace when you have finished. (Fig.5E)

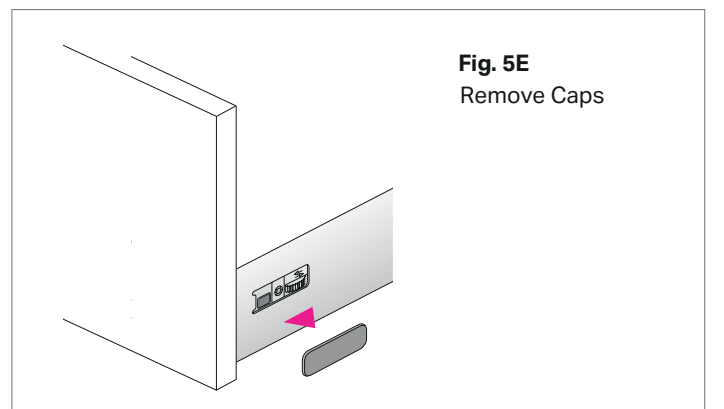

4. INSTALLATION INSTRUCTIONS | HETTICH DRAWER

5.3 Adjustment Continued

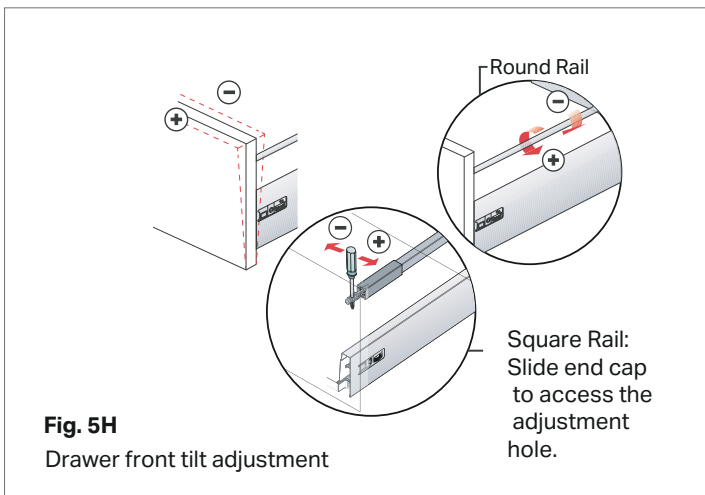
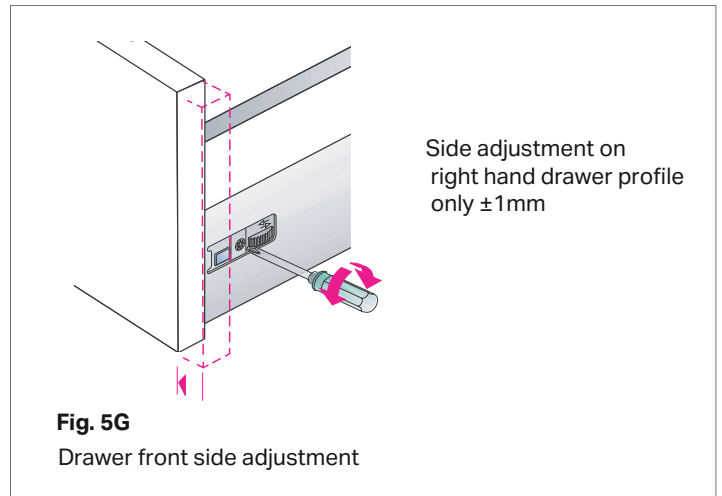
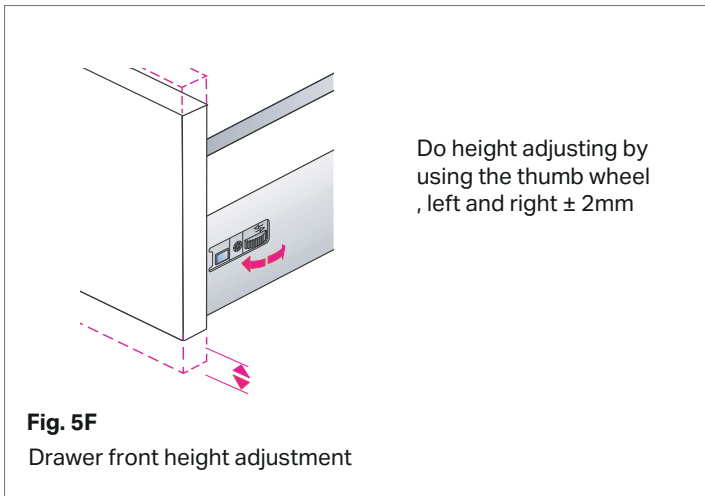

5. ELECTRICAL STANDARDS

5.1 Electrical Standards & Guidelines

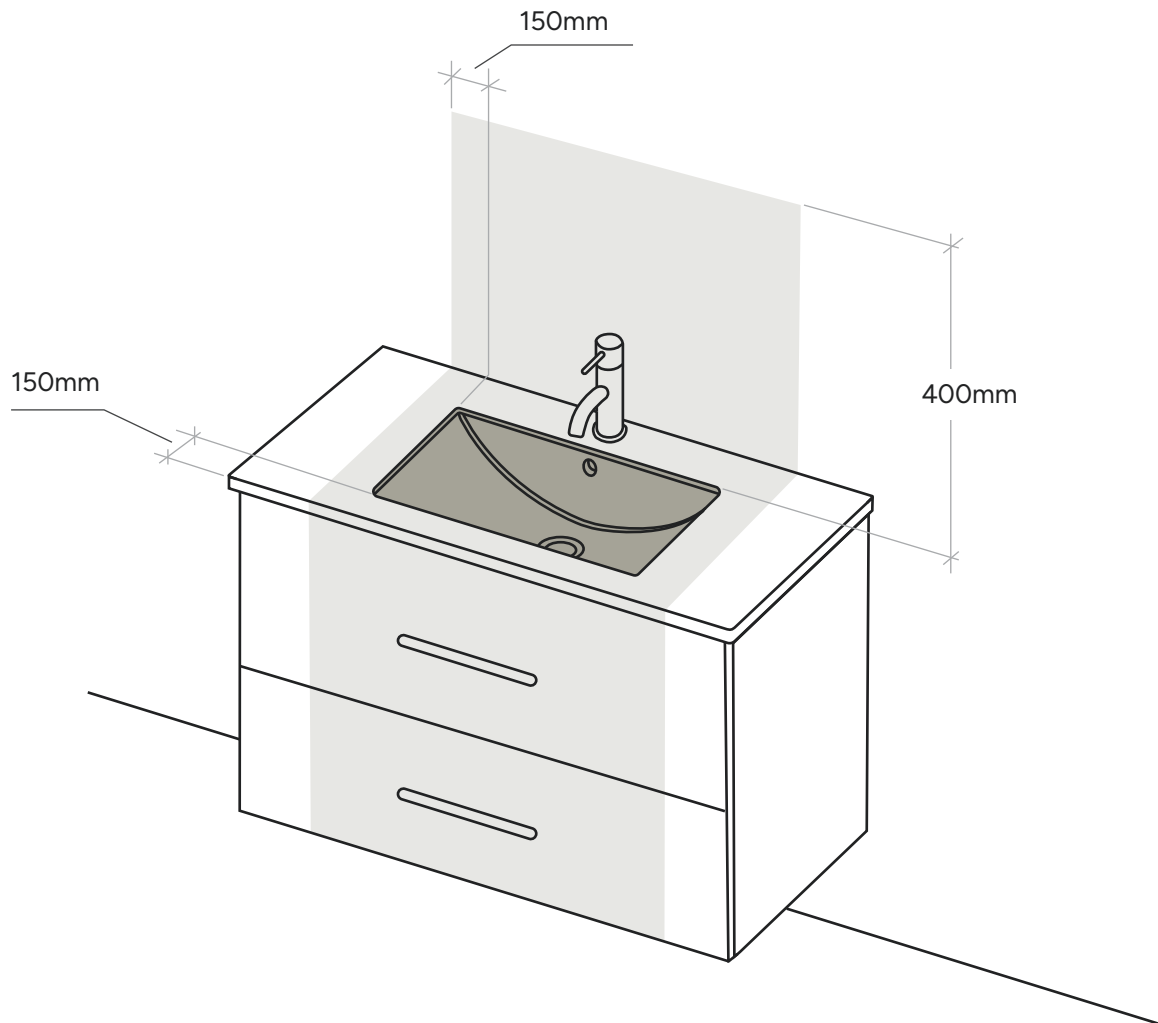

ZONE	AREA	ELECTRICAL ALLOWANCES
0	This is a fixed water container with a capacity not exceeding 45L, such as a basin or vessel.	No socket or lights in this area.
2	This is a measured area outside of the fixed water container	<p>Sockets are allowed if it is a shaver outlet complying with AS/NZS314.</p> <p>An RCD protected power point enclosed within a closed cupboard.</p> <p>IP44 LED lighting (ELV - Extra Low Voltage) with the controller positioned outside of Zone 2.</p>
Outside of Zone 0 & 2	You can have sockets and lights, all must be RCD protected to meet the requirements of clause: 1.5.5.2. The back of the socket needs to be protected, for example a case on the back of the socket installed on a drawer to meet clauses L 1.5.1, 1.5.3., 1.5.4.	

6. CARE & MAINTENANCE

6.1 Care & Maintenance

Products are produced from materials that are well suited to the bathroom. It is, however important that your bathroom is adequately ventilated to eliminate moisture build up. High humidity will lead to permanent dampness and mould resulting in a deterioration of the materials in your bathroom.



6.2 Cabinetry, handles & accessories

Cabinets are manufactured from high quality materials. These materials are water resistant and not water proof. To ensure a long life of the cabinet, water must not remain on the cabinet surfaces. All water spillages, leaks or flooding in or around the cabinet must be sponged off and dried immediately. Keep heat away from the cabinetry and avoid metal or other sharp objects which could scratch and damage the surface. Do not use abrasive cleaning agents which contain ammonia, bleach or other strong solvents. We also advise against the use of furniture polish, acetone, ethanol, benzene and coarse cleaning sponges. Carefully read the cleaner product label to ensure the cleaner is safe to use on the material.

For regular cleaning, we recommend cleaning with a soft cloth, wrung in hot water with a mild all-purpose cleaning agent. Cabinetry with structured surfaces is best cleaned along the structure to remove any dirt. Wipe clean with a damp cloth wrung in clean water to remove the cleaning agent and to avoid stains and stripes.

7. VANITY HANGING GUIDE

7.1 Vessel Basin on Slab Top

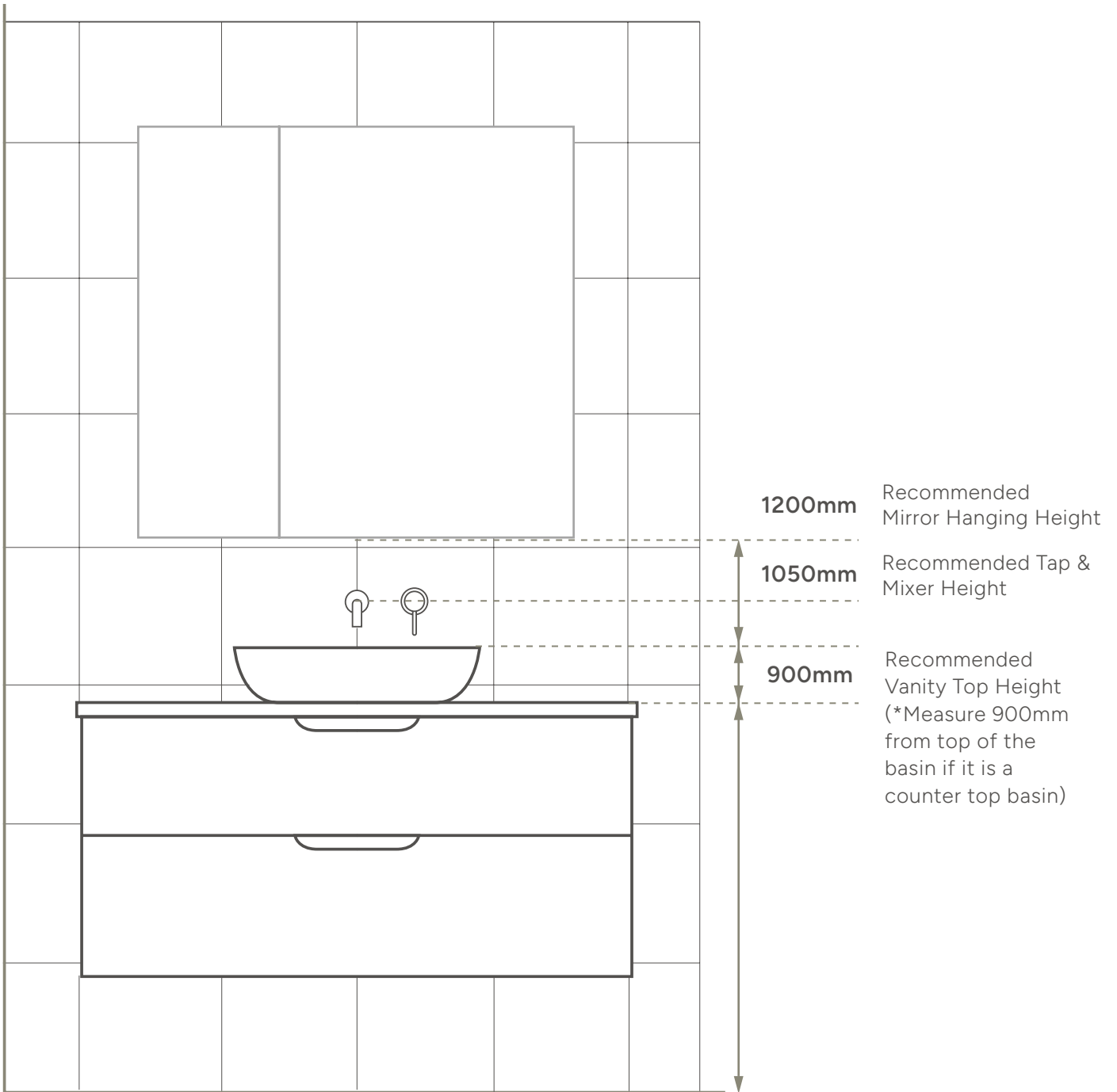

7. VANITY HANGING GUIDE

7.2 Inset Basin

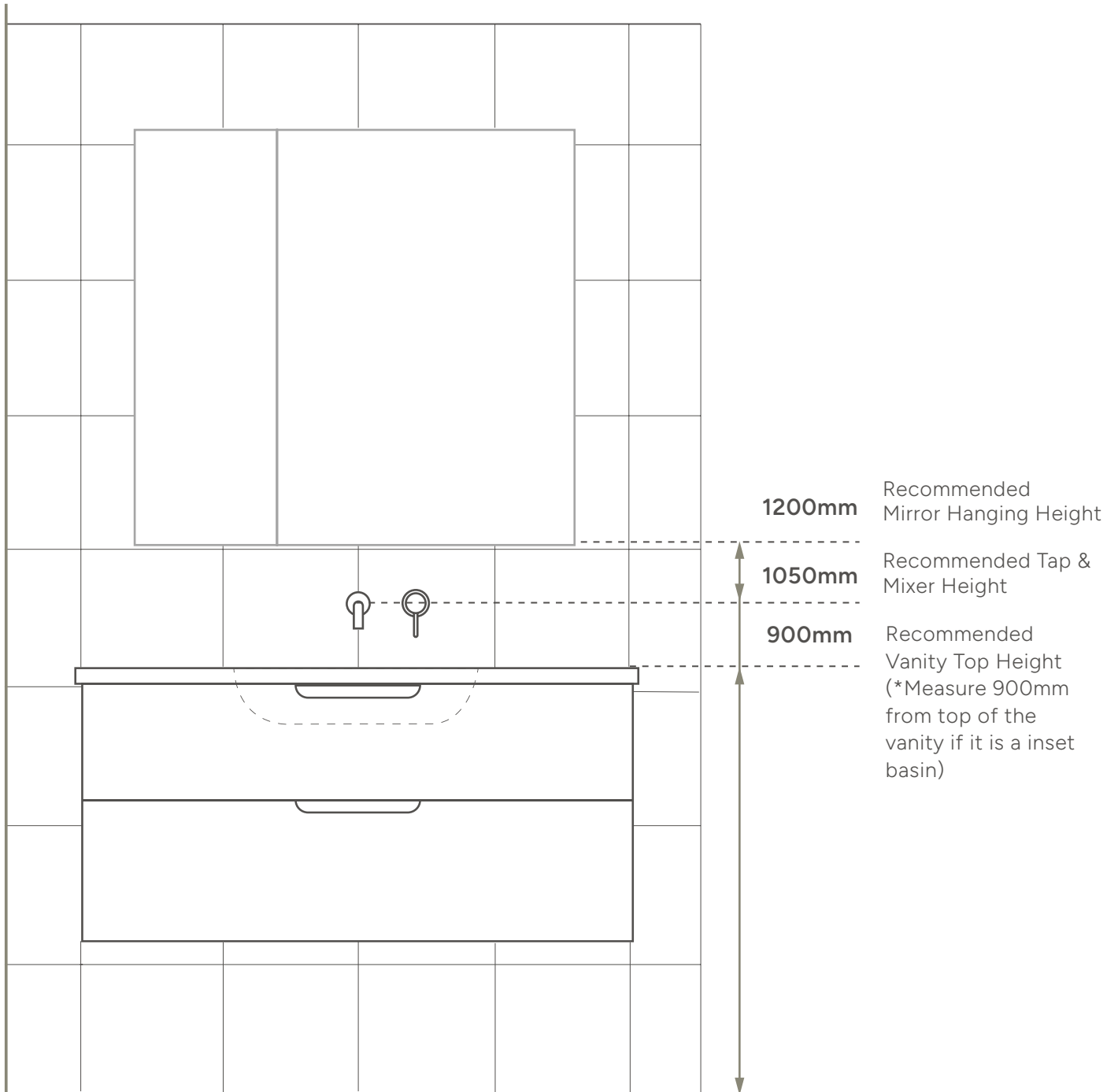

8. TROUBLESHOOTING

Problem	Likely Cause	Solution
I have noticed damage to my product, should I install it?	N/A	No, advise the store you purchased the product from before installing.
Where can I find specifications or more information for the product I have purchased?	N/A	Go to www.codeinteriors.co.nz .
My cabinet drawers are out of alignment.	There may have been some movement during transportation and installation which causes drawers to become unaligned.	Follow the corresponding instructions to adjust and align the drawer, found on page 7-8.
My drawer is not closing properly.	Incorrect installation, debris in the drawer runner or an obstruction preventing the drawer from closing.	<ul style="list-style-type: none">- Check the drawer box has been installed correctly (page 7-8)- Check the cabinet has been installed correctly (e.g. is it level and plumb?).- Check there is no debris in the drawer runners and vacuum out if there is.- Check there is nothing obstructing the drawer (e.g. plumbing or tap hose).
I am missing something from my order (e.g. Runners, Screws, Handles)	N/A	Notify the place of purchase of missing part.
My plug & waste is not sealing / holding water.	<ul style="list-style-type: none">- Debris build up e.g. soap scum, hair etc.- Not installed correctly.- Silicone has not been applied under waste rim, allowing water to escape.	<ul style="list-style-type: none">- Pull out the plug and clean thoroughly, removing any debris.- Ensure the plug is locked in place - push down until you hear a 'click' to provide a watertight seal.
I have a stain or mark on my vanity top or basin.	N/A	Identify benchtop or basin material and see care and maintenance guidelines on page 14 for appropriate cleaning guide.

9. WARRANTY

Product	Residential Warranty	Commercial Warranty
Vanities Nature	5 years	1 year
Vanities Lineare	5 years	1 year
Vanities Luxe	5 years	1 year
Vanities Hako	5 years	1 year
Code Vanity Tops		
Cove Concrete	10 years	1 year
Villastone Solid Surface	10 years	1 year
Pavia	5 years	1 year
Fusion Stainless Steel	15 years	1 year
Vanity Handles (Aura, Flow & Pure)	2 years	1 year

Our products come with guarantees that cannot be excluded under the New Zealand Consumer Law. You are entitled to a replacement or refund for a major failure upon inspection by an authorised representative where a product is found to be defective in construction, material or assembly. You are also entitled to have the goods repaired or replaced if the goods fail to be of acceptable quality and the failure does not amount to major failure, free of charge.

CONDITIONS

1. Items must be installed by a licensed tradesperson.
2. Failure is due to a fault in the manufacture of the product.
3. Proof of purchase is provided.
4. The installation of the product is in accordance with the instructions provided.

! Please report any issues with your product within 48 hours of receiving your goods, no claims will be considered after this time. No claims for damages or wrong product will be recognised after installation.

EXCLUSIONS

To the fullest extent permitted by law, the manufacturer excludes all liability for damage or injury to any person, damage to any property and any indirect consequential or other loss or damage. Manufacturer will not be liable for the cost of installation or removal of any unit and the warranty will be **voided** if damage occurred during or after **installation** or a damaged or incorrect unit has been installed.

Door and drawer adjustment; Unsuitable or improper use; Incorrect installation or installation not in accordance with the instructions provided; Installation or part installation by the purchaser or any person other than a **licensed** tradesperson; Normal wear and tear; Inadequate or complete lack of maintenance; chemical, electrochemical or electrical influences; excessive heat damage or harsh detergents or abrasive cleaners used on product finishes, are **NOT** considered a warranty issue.

Water damage is not covered under the Code Interiors Warranty.

Acrylic, Ceramic and Solid Surface basins and tops have a maximum water temperature of 65°C. Concrete basins have a maximum water temperature of 55°C

CLAIM PROCEDURE

For all warranty queries, customers are to contact the branch where the product was purchased (these details can be found on your purchase invoice).

9. WARRANTY

9.1 Service Call Out Fees & Charges

In the event of a call out for issues covered under the Code Interiors manufacturer warranty, no call out fees will apply.

If Code Interiors is called out and the cause of the issue falls within the warranty exclusions or the installation instructions have not been adhered to, the following charges will apply:

Call out fee: \$200.00 initial cost, first 15 minutes included.

Service time onsite: \$25/ billed in 15 minute increments.

Call out times: Business hours 9am - 4pm.

Note: Response time will depend on technician availability.

WARRANTY AGREEMENT | HOME OWNER MUST KEEP THIS SECTION

IMPORTANT: Warranty form to be completed by a licensed, qualified tradesperson responsible for the installation of this unit/

Any warranty will be **VOIDED** if this unit is not installed by a licensed, qualified tradesperson.

Cabinet Installed by:

Phone:

Trade & License Number:

Date: / /

Product name / description:

Purchase Date: / /