

INSTALLATION INSTRUCTIONS

Pavia 304SS Slide Shower

Mains Pressure Installation Only

ATTENTION PLUMBER

For best performance and to maintain customer satisfaction, please follow the guidelines below:

- Thoroughly flush all plumbing lines before beginning installation.
- Installation must comply with the AS/NZS 3500 standards.
- The maximum allowable operating pressure for any building is 500 kPa. Exceeding this limit can result in water hammer, premature wear on fixtures and appliances, and excessive noise throughout the system.
- A pressure-limiting valve is required if the supply pressure exceeds 500 kPa.

TECHNICAL INFORMATION

- This product is designed for high-pressure water systems only.
- It is not suitable for gravity-fed cylinders or low/unequal pressure installations.
- Minimum operating pressure: 150 kPa
- Maximum operating pressure: 500 kPa
- Maximum hot water temperature: 50°C
- If water temperature exceeds 50°C, an approved tempering valve must be installed.

Please leave this document with the product once installed.

For full warranty terms and conditions, please visit Codeinteriors.co.nz

BRACKET INSTALLATION

1. Measure and mark out the top and bottom mounting points to fix the mounting brackets.
 - A. The top bracket allows adjustment up to 650mm centres.
 - B. Ensure all marks are level and correctly aligned.
2. Drill holes and fix the brackets in place.
 - A. It is recommended to apply silicone sealant around the screw fixing points.

*All measurements are in millimetres. Sizes are nominal.

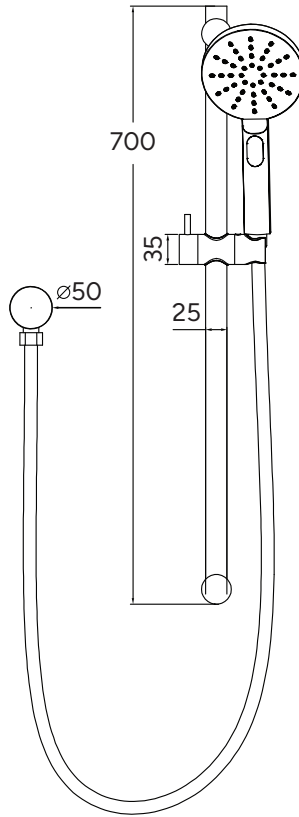
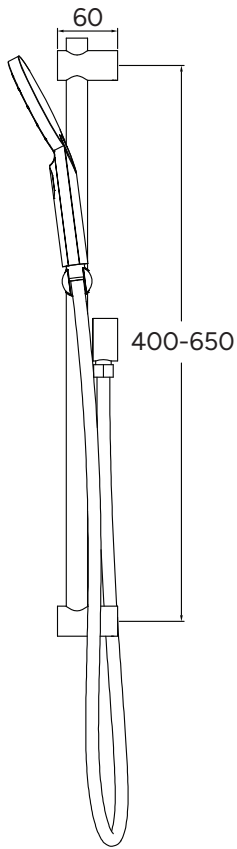

RAIL INSTALLATION

Push the slide rail onto the brackets and tighten the grub screws into the groove of each bracket.

Do not over-tighten.

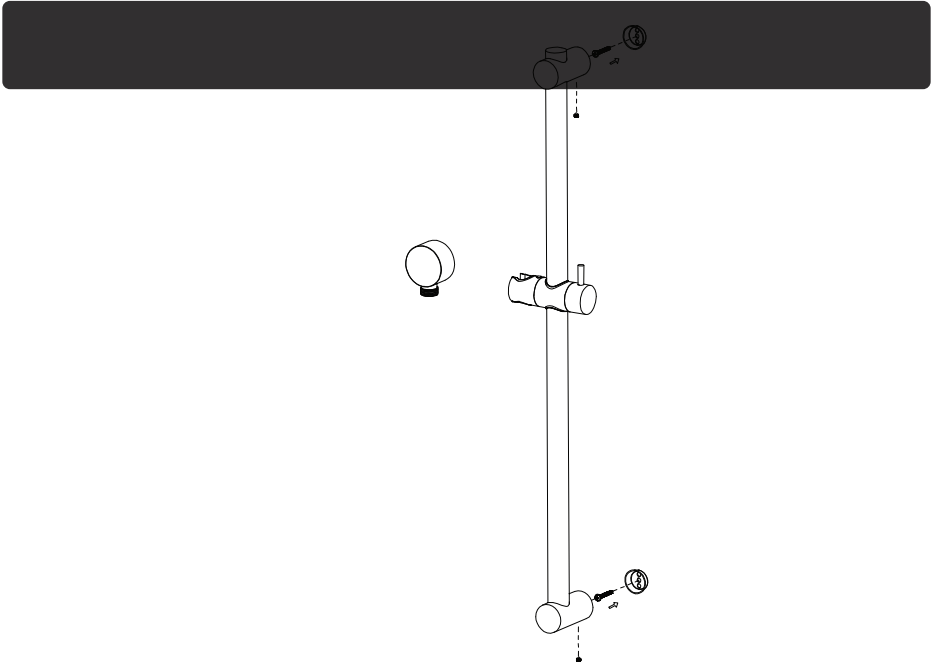

WALL ELBOW, HOSE & HAND SHOWER INSTALLATION:

1. Fit the wall elbow onto the ½" BSP male water outlet (not supplied).
2. Screw the hand shower onto the tapered end of the hose by hand, ensuring the sealing washer is correctly positioned.
3. Connect the nut end of the hose to the water outlet, confirm the washer is in place, and gently tighten with a spanner.

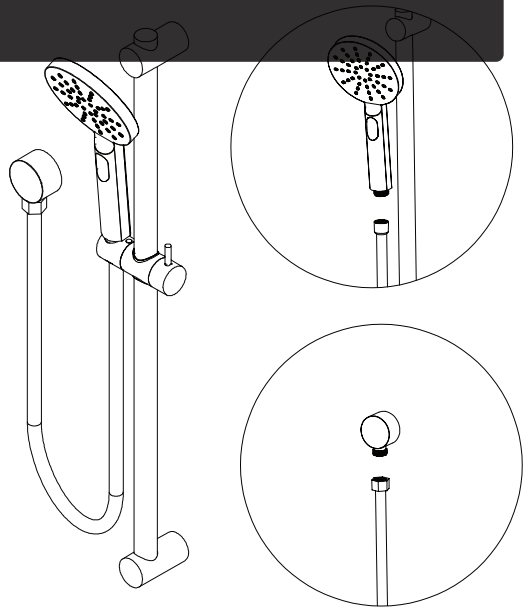

- Clean regularly using a soft cloth and mild, non-abrasive soap solution.
- Avoid using acidic, alkaline, or abrasive cleaners, scouring pads, or harsh chemicals, as they can damage the surface finish and internal components.
- After cleaning, rinse thoroughly with fresh water and dry with a soft cloth to prevent water spotting and mineral build-up.
- Periodically check all visible connections for signs of leaks, looseness, or wear.
- Ensure the hot and cold supply pressures remain within the manufacturer's recommended limits to protect the product and prolong service life.

Regular maintenance will help preserve appearance, ensure smooth

In accordance with our continuous product development, Code Interiors' sizes and specifications outlined in these specifications are subject to change without notice. Information detailed in this document represents actual product available at the time of publishing this sheet. For the latest version of this technical document please visit www.codeinteriors.co.nz or contact your nearest stockist to confirm any questions prior to purchase.

operation, and extend the lifespan of the slide shower.

**TERM 10 YEARS
(5 YEARS PARTS & LABOUR, 5 YEARS PARTS ONLY)**

- This slide shower is covered by a manufacturer's warranty that applies to defects in materials or workmanship under normal residential use.
- The warranty period begins from the original date of purchase; proof of purchase is required for all claims.

- The warranty applies only when the product has been installed by a licensed plumber and maintained in accordance with the care and maintenance guidelines.
- The warranty does not cover damage resulting from incorrect installation, misuse, accidental damage, alterations, chemical exposure, or normal wear and tear.
- Components such as cartridges, seals, and aerators may have separate warranty terms or may be considered consumable items.
- If a defect is confirmed, the manufacturer will repair, replace, or supply replacement parts at their discretion. Labour, removal, or reinstallation costs may not be covered.
- For any warranty enquiry, contact the supplier or manufacturer with details of the issue, installation date, and proof of purchase.

A properly installed and maintained slide shower will provide reliable service and ensure full warranty protection.

